

THIS DRAWING IS UNPUBLISHED. RELEASED FOR PUBLICATION
 © COPYRIGHT BY TYCO ELECTRONICS CORPORATION. ALL RIGHTS RESERVED.

LOC	DIST	REVISIONS					
AJ	16	P	LTR	DESCRIPTION	DATE	DWN	APVD
			R1	REVISED PER ECO-06-018765	13APR07	DH	DB

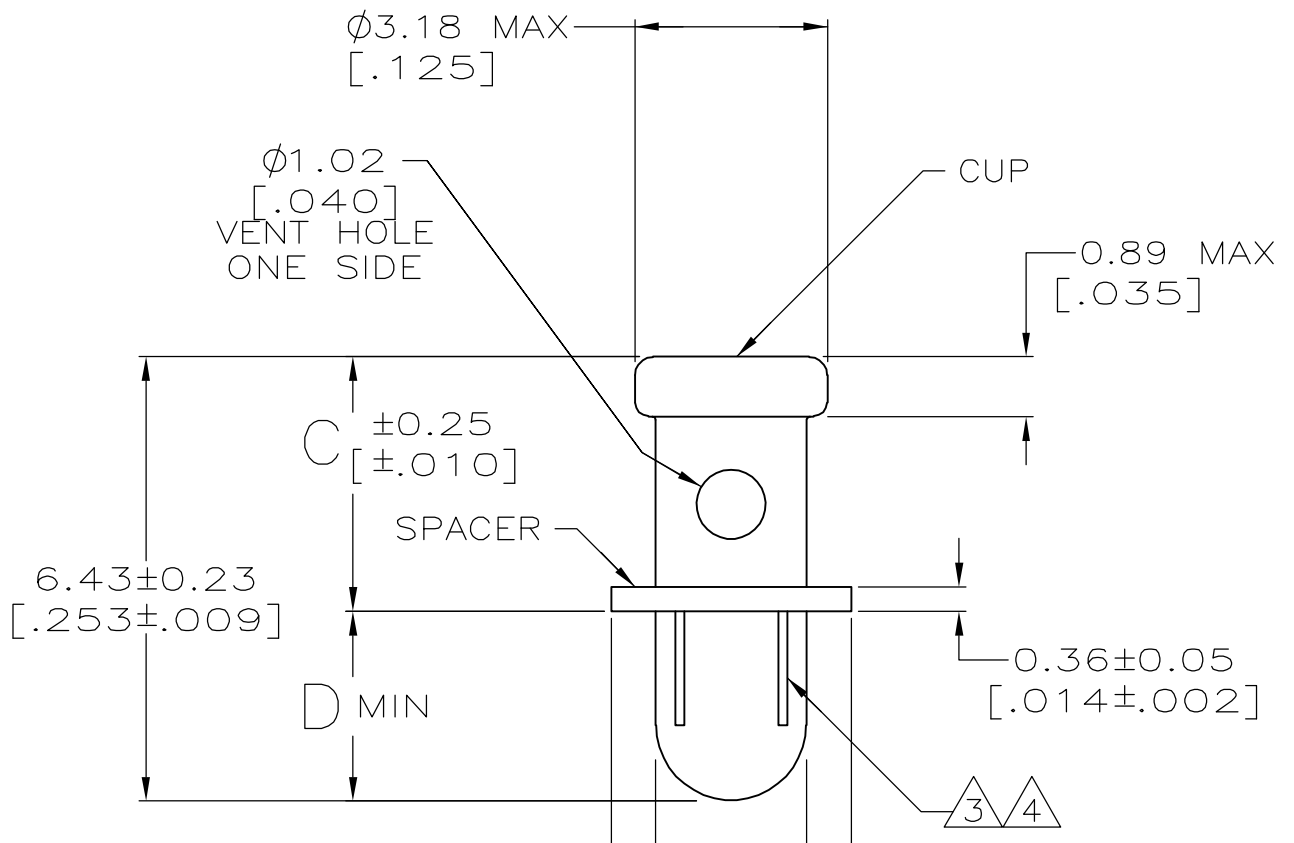
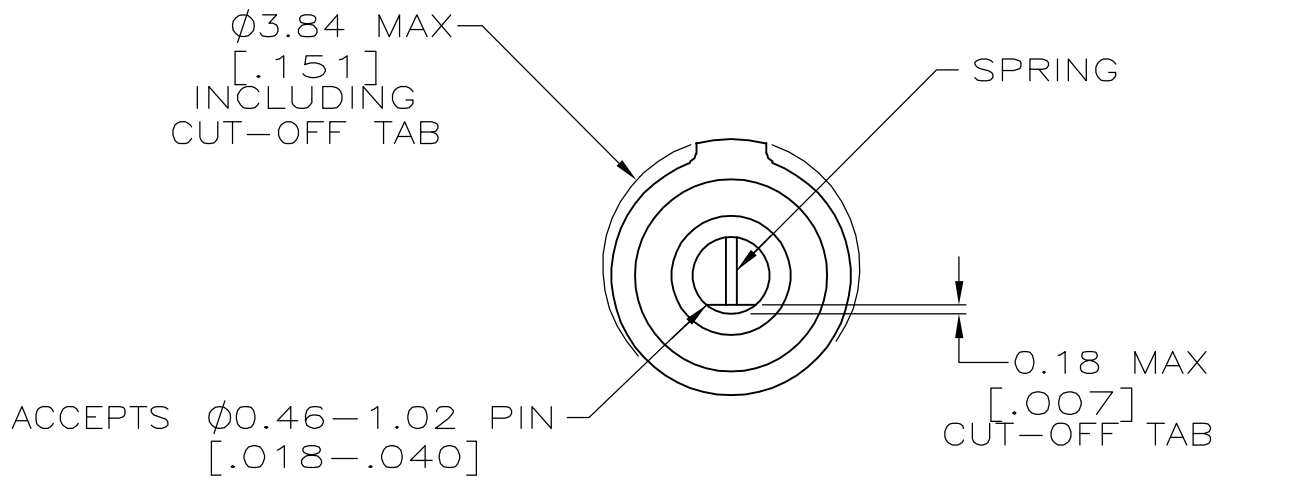

- ① CUP: COPPER.
SPACER: BRASS.
SPRING: BERYLLIUM COPPER.
- ② CUP: $2.54 \mu\text{m}$ [0.000100] MIN TIN-LEAD.
SPACER: $2.03 \mu\text{m}$ [0.000080] MIN TIN-LEAD OVER
 $1.27 \mu\text{m}$ [0.000050] MIN NICKEL.
SPRING: GOLD FLASH OVER $1.27 \mu\text{m}$ [0.000050] MIN NICKEL.
 $0.76 \mu\text{m}$ [0.000030] MIN GOLD IN CONTACT AREA.
- ③ 4 BARE LINES 90° APART ON OUTSIDE OF CUP.
- ④ $\phi 2.11$ [0.083] MIN ACROSS BARE METAL.
- ⑤ FITS INTO $\phi 2.261 \pm 0.038$ [0.0890 ± 0.0015] HOLE, FOR HAND INSERTION.
- 6. 3.68 [0.145] MIN INSERTION DEPTH FOR RELIABLE CONTACT OF COMPONENT LEAD.
- 7. AFTER SIZING WITH PIN "A", SAME PART MUST MEET EXTRACTION FORCE WITH PIN "B".

PIN "A" DIA	MAX INSERTION FORCE GRAMS [OUNCES]	PIN "B" DIA	MIN EXTRACTION FORCE GRAMS [OUNCES]
0.51 [0.020]	482 [17]	0.46 [0.018]	28.3 [1.0]
0.81 [0.032]	1049 [37]	0.64 [0.025]	42.5 [1.5]
1.02 [0.040]	1361 [48]	0.89 [0.035]	56.7 [2.0]

⑧ SUPERSEDED BY 1-380737-0.

	2.90 [.114]	3.05 [.120]	1-380737-1 ⑧
OBSOLETE	2.16 [.085]	3.68 [.145]	1-380737-0
	D	C	PART NUMBER

⑤ $\phi 2.26$ [.089]
 $\phi 2.18$ [.086]

THIS DRAWING IS A CONTROLLED DOCUMENT.

DIMENSIONS: mm [INCHES]	TOLERANCES UNLESS OTHERWISE SPECIFIED:	DWN D.HARDY 22 DEC 99	 Tyco Electronics Corporation Harrisburg, Pa 17105-3608
	0 PLC ± - 1 PLC ± - 2 PLC ± 0.38 [.015] 3 PLC ± - 4 PLC ± - ANGLES ± 1°	CHK H.WYNKOOP 19 JAN 00	
		APVD H.WYNKOOP 19 JAN 00	
MATERIAL ①	FINISH ②	PRODUCT SPEC -	NAME RECEPTACLE ASSEMBLY, REUSABLE COMPONENT
		APPLICATION SPEC -	SIZE A3 CAGE CODE 00779 DRAWING NO C-380737 RESTRICTED TO -
		WEIGHT -	SCALE 10:1 SHEET 1 OF 1 REV R1

CUSTOMER DRAWING